



CONNECT AND PROTECT

nVent ERICO Electrical Earth Bars

nVent

ERICO

Introduction



nVent ERICO Electrical Earth Bars (EEB) provide a common earthing point for multiple electrical panels and devices. Earth bars are a key component of the nVent ERICO foundation for protection plan and help to eliminate the risk of earth potential loops in large complexes and buildings. Disconnect links allow for quick and easy testing of the earth termination system. nVent uses high quality components to ensure easy assembly, reliable service and installation longevity. Custom designs are available upon request.

STANDARD PART NUMBER LOGIC

CUSTOM DESIGNS ALSO AVAILABLE

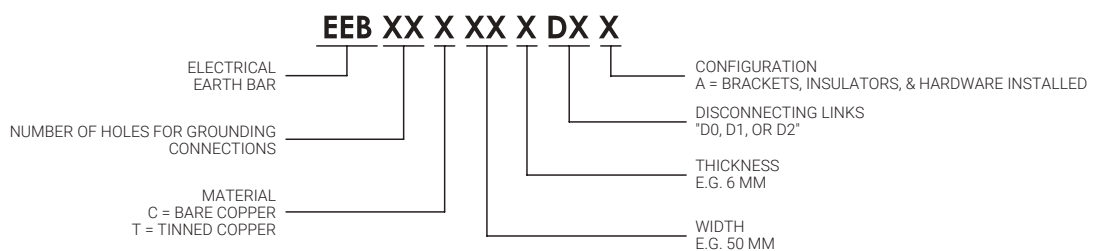

Electrical Earth Bar

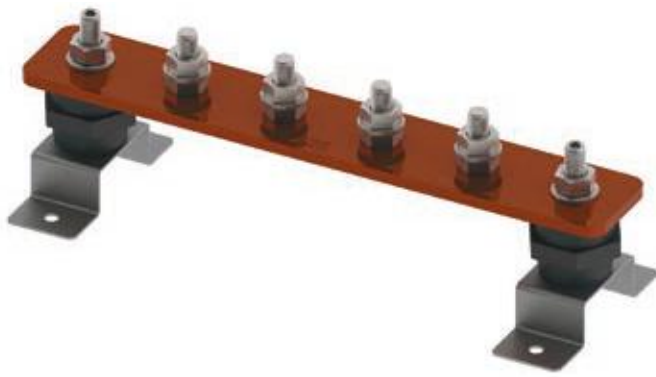

FEATURES

- Provides a convenient, single-point grounding and bonding location
- Busbars with disconnect links allow for convenient testing of the earth termination system
- High conductivity, hard drawn, electrolytic tough pitch copper per EN 13601
- Includes halogen-free polyamide insulators, stainless steel (EN 1.4401) hardware and mounting brackets
- Custom bars can be designed and manufactured to customer specifications

Part Number	Number of Connections	Thread Size (TS)	Height (H)	Length (L)	Width 1 (W1)	Width 2 (W2)	Thickness (T)	Hole Centers (A)	Unit Weight
Finish: Bare Copper Bar									
EEB04C506D0A	4	M10	94 mm	300 mm	100 mm	50 mm	6 mm	50 mm	1.45 kg
EEB06C506D0A	6	M10	94 mm	400 mm	100 mm	50 mm	6 mm	50 mm	1.84 kg
EEB08C506D0A	8	M10	94 mm	500 mm	100 mm	50 mm	6 mm	50 mm	2.23 kg
EEB10C506D0A	10	M10	94 mm	600 mm	100 mm	50 mm	6 mm	50 mm	2.63 kg
EEB12C506D0A	12	M10	94 mm	700 mm	100 mm	50 mm	6 mm	50 mm	3.03 kg
EEB14C506D0A	14	M10	94 mm	850 mm	100 mm	50 mm	6 mm	50 mm	3.75 kg
EEB16C506D0A	16	M10	94 mm	950 mm	100 mm	50 mm	6 mm	50 mm	4.14 kg
EEB18C506D0A	18	M10	94 mm	1,050 mm	100 mm	50 mm	6 mm	50 mm	4.54 kg
EEB20C506D0A	20	M10	94 mm	1,150 mm	100 mm	50 mm	6 mm	50 mm	4.93 kg
EEB22C506D0A	22	M10	94 mm	1,250 mm	100 mm	50 mm	6 mm	50 mm	5.33 kg
EEB24C506D0A	24	M10	94 mm	1,350 mm	100 mm	50 mm	6 mm	50 mm	5.72 kg
EEB26C506D0A	26	M10	94 mm	1,500 mm	100 mm <td 50 mm	6 mm	50 mm	6.44 kg	
EEB28C506D0A	28	M10	94 mm	1,600 mm	100 mm	50 mm	6 mm	50 mm	6.84 kg
EEB30C506D0A	30	M10	94 mm	1,700 mm	100 mm	50 mm	6 mm	50 mm	7.23 kg
Finish: Tinned Copper Bar									
EEB04T506D0A	4	M10	94 mm	300 mm	100 mm	50 mm	6 mm	50 mm	1.47 kg
EEB06T506D0A	6	M10	94 mm	400 mm	100 mm	50 mm	6 mm	50 mm	1.87 kg
EEB08T506D0A	8	M10	94 mm	500 mm	100 mm	50 mm	6 mm	50 mm	2.27 kg
EEB10T506D0A	10	M10	94 mm	600 mm	100 mm	50 mm	6 mm	50 mm	2.67 kg
EEB12T506D0A	12	M10	94 mm	700 mm	100 mm	50 mm	6 mm	50 mm	3.07 kg
EEB14T506D0A	14	M10	94 mm	850 mm	100 mm	50 mm	6 mm	50 mm	3.81 kg
EEB16T506D0A	16	M10	94 mm	950 mm	100 mm	50 mm	6 mm	50 mm	4.21 kg
EEB18T506D0A	18	M10	94 mm	1,050 mm	100 mm	50 mm	6 mm	50 mm	4.61 kg
EEB20T506D0A	20	M10	94 mm	1,150 mm	100 mm	50 mm	6 mm	50 mm	5.01 kg
EEB22T506D0A	22	M10	94 mm	1,250 mm	100 mm	50 mm	6 mm	50 mm	5.41 kg
EEB24T506D0A	24	M10	94 mm	1,350 mm	100 mm	50 mm	6 mm	50 mm	5.81 kg
EEB26T506D0A	26	M10	94 mm	1,500 mm	100 mm	50 mm	6 mm	50 mm	6.54 kg
EEB28T506D0A	28	M10	94 mm	1,600 mm	100 mm	50 mm	6 mm	50 mm	6.94 kg
EEB30T506D0A	30	M10	94 mm	1,700 mm	100 mm	50 mm	6 mm	50 mm	7.34 kg

Tinned finish is 8 microns according to ASTM B545 Service Class "C" for corrosive environments.

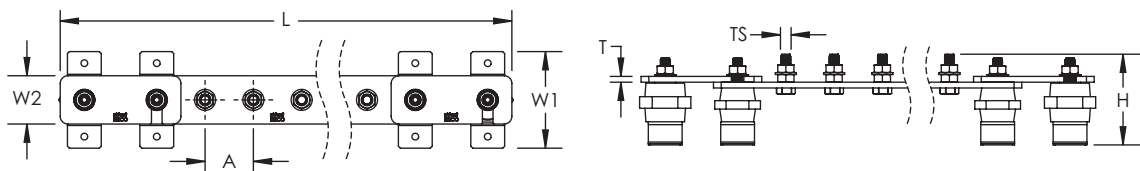

Electrical Earth Bar – Single Disconnect Link



FEATURES

- Provides a convenient, single-point grounding and bonding location
- Busbars with disconnect links allow for convenient testing of the earth termination system
- High conductivity, hard drawn, electrolytic tough pitch copper per EN 13601
- Includes halogen-free polyamide insulators, stainless steel (EN 1.4401) hardware and mounting brackets
- Custom bars can be designed and manufactured to customer specifications

Part Number	Number of Connections	Thread Size (TS)	Height (H)	Length (L)	Width 1 (W1)	Width 2 (W2)	Thickness (T)	Hole Centers (A)	Unit Weight
Finish: Bare Copper Bar									
EEB04C506D1A	4	M10	94 mm	375 mm	100 mm	50 mm	6 mm	50 mm	2.06 kg
EEB06C506D1A	6	M10	94 mm	475 mm	100 mm	50 mm	6 mm	50 mm	2.45 kg
EEB08C506D1A	8	M10	94 mm	575 mm	100 mm	50 mm	6 mm	50 mm	2.85 kg
EEB10C506D1A	10	M10	94 mm	675 mm	100 mm	50 mm	6 mm	50 mm	3.24 kg
EEB12C506D1A	12	M10	94 mm	775 mm	100 mm	50 mm	6 mm	50 mm	3.64 kg
EEB14C506D1A	14	M10	94 mm	925 mm	100 mm	50 mm	6 mm	50 mm	4.36 kg
EEB16C506D1A	16	M10	94 mm	1,025 mm	100 mm	50 mm	6 mm	50 mm	4.76 kg
EEB18C506D1A	18	M10	94 mm	1,125 mm	100 mm	50 mm	6 mm	50 mm	5.15 kg
EEB20C506D1A	20	M10	94 mm	1,225 mm	100 mm	50 mm	6 mm	50 mm	5.54 kg
EEB22C506D1A	22	M10	94 mm	1,325 mm	100 mm	50 mm	6 mm	50 mm	5.94 kg
EEB24C506D1A	24	M10	94 mm	1,425 mm	100 mm	50 mm	6 mm	50 mm	6.33 kg
EEB26C506D1A	26	M10	94 mm	1,575 mm	100 mm	50 mm	6 mm	50 mm	7.05 kg
EEB28C506D1A	28	M10	94 mm	1,675 mm	100 mm	50 mm	6 mm	50 mm	7.45 kg
EEB30C506D1A	30	M10	94 mm	1,775 mm	100 mm	50 mm	6 mm	50 mm	7.84 kg
Finish: Tinned Copper Bar									
EEB04T506D1A	4	M10	94 mm	375 mm	100 mm	50 mm	6 mm	50 mm	2.08 kg
EEB06T506D1A	6	M10	94 mm	475 mm	100 mm	50 mm	6 mm	50 mm	2.48 kg
EEB08T506D1A	8	M10	94 mm	575 mm	100 mm	50 mm	6 mm	50 mm	2.89 kg
EEB10T506D1A	10	M10	94 mm	675 mm	100 mm	50 mm	6 mm	50 mm	3.29 kg
EEB12T506D1A	12	M10	94 mm	775 mm	100 mm	50 mm	6 mm	50 mm	3.67 kg
EEB14T506D1A	14	M10	94 mm	925 mm	100 mm	50 mm	6 mm	50 mm	4.42 kg
EEB16T506D1A	16	M10	94 mm	1,025 mm	100 mm	50 mm	6 mm	50 mm	4.82 kg
EEB18T506D1A	18	M10	94 mm	1,125 mm	100 mm	50 mm	6 mm	50 mm	5.22 kg
EEB20T506D1A	20	M10	94 mm	1,225 mm	100 mm	50 mm	6 mm	50 mm	5.62 kg
EEB22T506D1A	22	M10	94 mm	1,325 mm	100 mm	50 mm	6 mm	50 mm	6.02 kg
EEB24T506D1A	24	M10	94 mm	1,425 mm	100 mm	50 mm	6 mm	50 mm	6.42 kg
EEB26T506D1A	26	M10	94 mm	1,575 mm	100 mm	50 mm	6 mm	50 mm	7.16 kg
EEB28T506D1A	28	M10	94 mm	1,675 mm	100 mm	50 mm	6 mm	50 mm	7.56 kg
EEB30T506D1A	30	M10	94 mm	1,775 mm	100 mm	50 mm	6 mm	50 mm	7.96 kg

Tinned finish is 8 microns according to ASTM B545 Service Class "C" for corrosive environments.

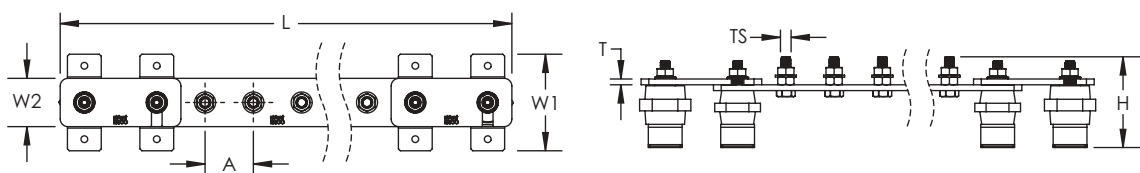

Electrical Earth Bar – Double Disconnect Links



FEATURES

- Provides a convenient, single-point grounding and bonding location
- Busbars with disconnect links allow for convenient testing of the earth termination system
- High conductivity, hard drawn, electrolytic tough pitch copper per EN 13601
- Includes halogen-free polyamide insulators, stainless steel (EN 1.4401) hardware and mounting brackets
- Custom bars can be designed and manufactured to customer specifications

Part Number	Number of Connections	Thread Size (TS)	Height (H)	Length (L)	Width 1 (W1)	Width 2 (W2)	Thickness (T)	Hole Centers (A)	Unit Weight
Finish: Bare Copper Bar									
EEB04C506D2A	4	M10	94 mm	450 mm	100 mm	50 mm	6 mm	50 mm	2.67 kg
EEB06C506D2A	6	M10	94 mm	550 mm	100 mm	50 mm	6 mm	50 mm	3.07 kg
EEB08C506D2A	8	M10	94 mm	650 mm	100 mm	50 mm	6 mm	50 mm	3.46 kg
EEB10C506D2A	10	M10	94 mm	750 mm	100 mm	50 mm	6 mm	50 mm	3.86 kg
EEB12C506D2A	12	M10	94 mm	850 mm	100 mm	50 mm	6 mm	50 mm	4.25 kg
EEB14C506D2A	14	M10	94 mm	1,000 mm	100 mm	50 mm	6 mm	50 mm	4.97 kg
EEB16C506D2A	16	M10	94 mm	1,100 mm	100 mm	50 mm	6 mm	50 mm	5.37 kg
EEB18C506D2A	18	M10	94 mm	1,200 mm	100 mm <td 50 mm	6 mm	50 mm	5.76 kg	
EEB20C506D2A	20	M10	94 mm	1,300 mm	100 mm	50 mm	6 mm	50 mm	6.15 kg
EEB22C506D2A	22	M10	94 mm	1,400 mm	100 mm	50 mm	6 mm	50 mm	6.55 kg
EEB24C506D2A	24	M10	94 mm	1,500 mm	100 mm	50 mm	6 mm	50 mm	6.94 kg
EEB26C506D2A	26	M10	94 mm	1,650 mm	100 mm	50 mm	6 mm	50 mm	7.66 kg
EEB28C506D2A	28	M10	94 mm	1,750 mm	100 mm	50 mm	6 mm	50 mm	8.06 kg
EEB30C506D2A	30	M10	94 mm	1,850 mm	100 mm	50 mm	6 mm	50 mm	8.45 kg
Finish: Tinned Copper Bar									
EEB04T506D2A	4	M10	94 mm	450 mm	100 mm	50 mm	6 mm	50 mm	2.70 kg
EEB06T506D2A	6	M10	94 mm	550 mm	100 mm	50 mm	6 mm	50 mm	3.10 kg
EEB08T506D2A	8	M10	94 mm	650 mm	100 mm	50 mm	6 mm	50 mm	3.50 kg
EEB10T506D2A	10	M10	94 mm	750 mm	100 mm	50 mm	6 mm	50 mm	3.90 kg
EEB12T506D2A	12	M10	94 mm	850 mm	100 mm	50 mm	6 mm	50 mm	4.30 kg
EEB14T506D2A	14	M10	94 mm	1,000 mm	100 mm	50 mm	6 mm	50 mm	5.03 kg
EEB16T506D2A	16	M10	94 mm	1,100 mm	100 mm	50 mm	6 mm	50 mm	5.43 kg
EEB18T506D2A	18	M10	94 mm	1,200 mm	100 mm	50 mm	6 mm	50 mm	5.83 kg
EEB20T506D2A	20	M10	94 mm	1,300 mm	100 mm	50 mm	6 mm	50 mm	6.23 kg
EEB22T506D2A	22	M10	94 mm	1,400 mm	100 mm	50 mm	6 mm	50 mm	6.64 kg
EEB24T506D2A	24	M10	94 mm	1,500 mm	100 mm	50 mm	6 mm	50 mm	7.04 kg
EEB26T506D2A	26	M10	94 mm	1,650 mm	100 mm	50 mm	6 mm	50 mm	7.77 kg
EEB28T506D2A	28	M10	94 mm	1,750 mm	100 mm	50 mm	6 mm	50 mm	8.17 kg
EEB30T506D2A	30	M10	94 mm	1,850 mm	100 mm	50 mm	6 mm	50 mm	8.57 kg

Tinned finish is 8 microns according to ASTM B545 Service Class "C" for corrosive environments.

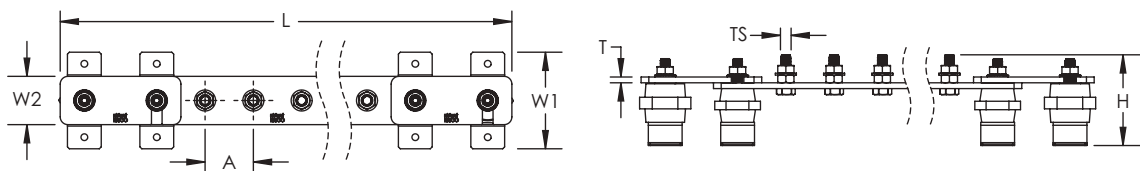

Disconnecting Link



FEATURES

- Allows for quick and easy disconnection of the earthing system to facilitate testing of the earth in isolation
- High conductivity, hard drawn, electrolytic tough pitch copper per EN 13601
- Includes halogen-free polyamide insulators, stainless steel (EN 1.4401) hardware and mounting brackets

Part Number	Thread Size (TS)	Height (H)	Length (L)	Width 1 (W1)	Width 2 (W2)	Thickness (T)	Unit Weight
Finish: Bare Copper Bar							
DLINKC	M10	90 mm	125 mm	100 mm	50 mm	6 mm	0.77 kg
Finish: Tinned Copper Bar							
DLINKT	M10	90 mm	125 mm	100 mm	50 mm	6 mm	0.77 kg

Tinned finish is 8 microns according to ASTM B545 Service Class "C" for corrosive environments.

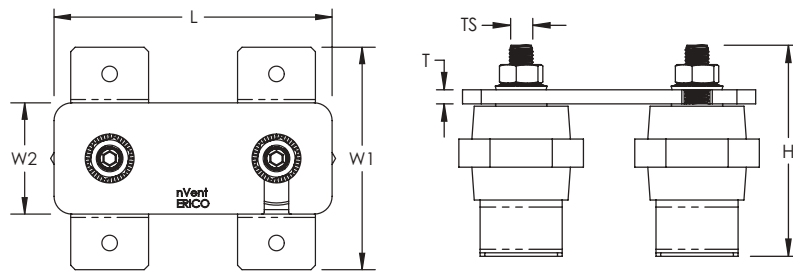

Swan-Neck Link



FEATURES

- Standalone link that joins two or more nVent ERICO electrical earth bars
- High conductivity, hard drawn, electrolytic tough pitch copper per EN 13601

Part Number	Length (L)	Width (W)	Thickness (T)	Unit Weight
Finish: Bare Copper Bar				
EEBDLC	125 mm	50 mm	6 mm	0.30 kg
Finish: Tinned Copper Bar				
EEBDLT	125 mm	50 mm	6 mm	0.30 kg

Tinned finish is 8 microns according to ASTM B545 Service Class "C" for corrosive environments.

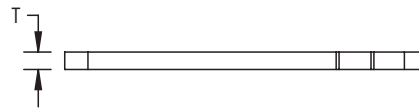
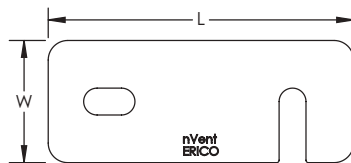

Our powerful portfolio of brands:

CADDY ERICO HOFFMAN RAYCHEM SCHROFF TRACER



[nVent.com/ERICO](https://www.nVent.com/ERICO)